

The background image is a dark, moody photograph of a park. It features a line of trees in the middle ground and a grassy field in the foreground. The sky is overcast with grey clouds. The overall tone is somber and naturalistic.

Feasibility Study for the Irvine Great Park Library



RIVERSIDE

COSTA MESA

MANHATTAN BEACH

BEVERLY HILLS

Schedule

- Discovery Phase Aug. 14 – Oct. 5
- Option Development Phase Oct 5 – Dec. 6
- Final Documents Phase Dec. 7 – Jan. 23

Public Outreach

- Meetings with stakeholders (UCI, School Districts, FOTL, etc.)
- Irvine Great Park Task Force Meeting: Oct. 5 6:00 PM
- Community Townhall # 1: Oct. 25 6:00 PM
- Community Townhall #2: Week of Nov. 13
- Community Services Commission: Nov. 15 5:30 PM

RIDGE VALLEY

PUSAN

CADENCE

CHINON

MARINE WAY



GREAT PARK: 1,300 ACRES



BOTANIC TERRACE

GREAT PARK VICINITY PLAN



FAA BUILDING

VETERANS MEMORIAL PARK AND GARDENS

ARBORETUM

LIBRARY SITE

WASH

GREAT PARK VICINITY PLAN

PUSAN

CADENCE

LIBRARY SITE

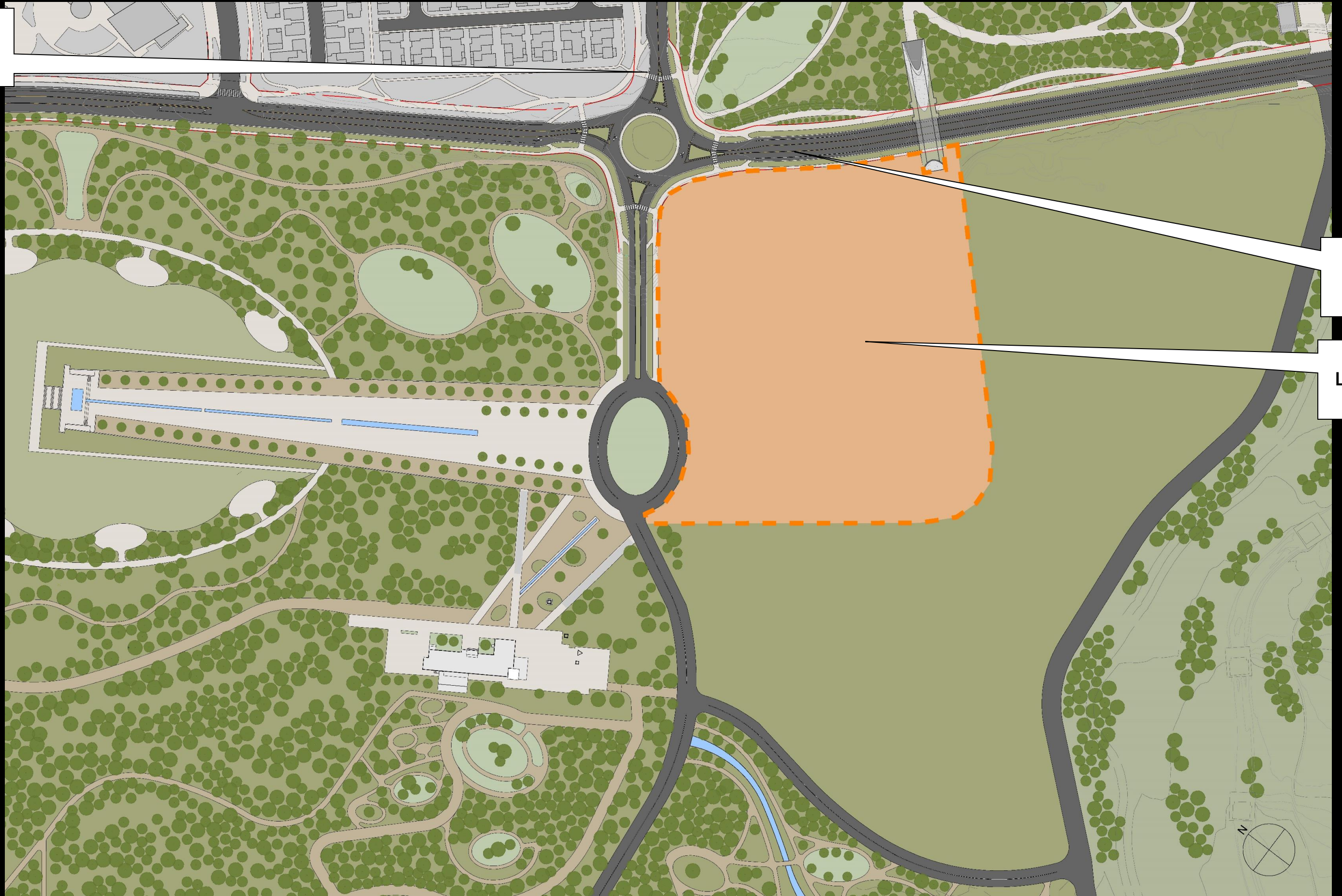

LIBRARY SITE PLAN



BIKE TUNNEL

LIBRARY SITE

WASH

VETERANS MEMORIAL

BOTANIC TERRACE

FAA BUILDING

LIBRARY SITE PLAN

KATIE WHEELER BRANCH LIBRARY

HERITAGE PARK BRANCH LIBRARY

UNIVERSITY PARK BRANCH LIBRARY

GREAT PARK MAIN LIBRARY SITE

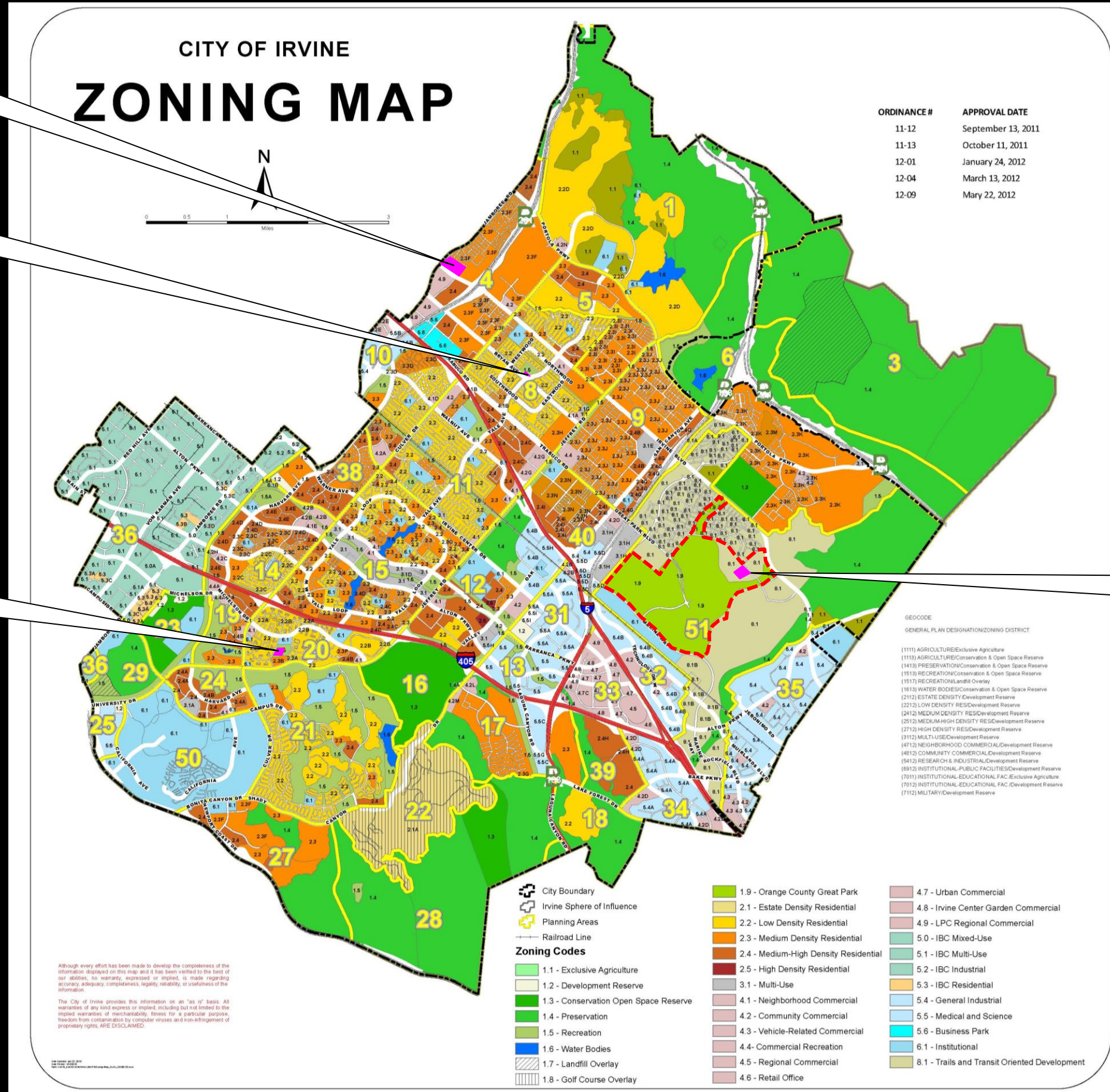

EXISTING BRANCH LOCATIONS

CITY OF IRVINE ZONING MAP



BEACON PARK K-8 SCHOOL

- 11-12 September 13, 2011
- 11-13 October 11, 2011
- 12-01 January 24, 2012
- 12-04 March 13, 2012
- 12-09 May 22, 2012

LOMA RIDGE ELEMENTARY

PORTOLA SPRINGS ELEMENTARY

CADENCE PARK SCHOOL

MAIN LIBRARY SITE

PORTOLA HIGH SCHOOL

SOLIS PARK SCHOOL

IRVINE VALLEY COLLEGE

UC IRVINE

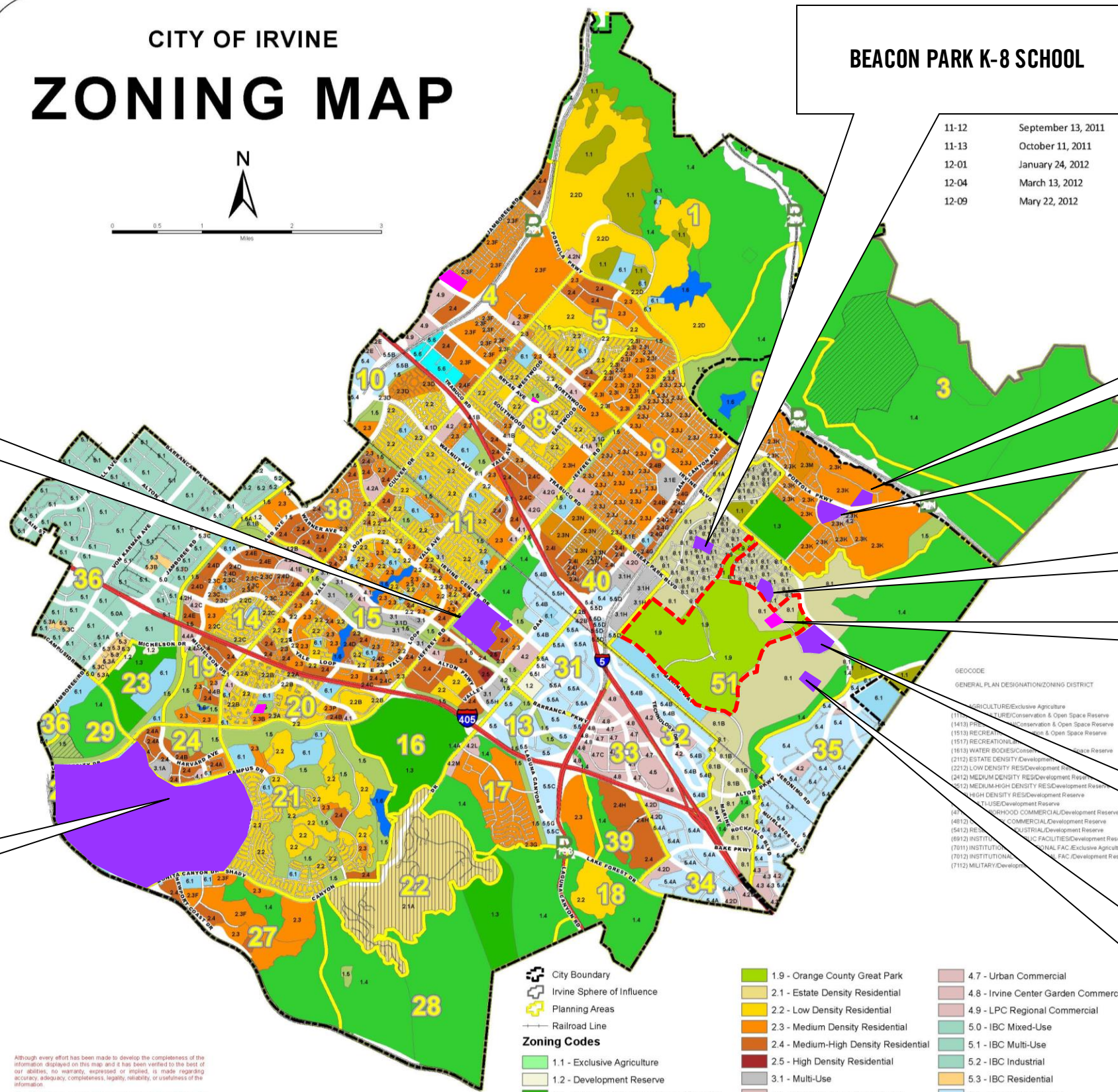

KEY STAKEHOLDERS



AERIAL VIEW OF SITE LOOKING NORTH



VETERANS MEMORIAL

ARBORETUM

BIKE TUNNEL

LIBRARY SITE

FAA BUILDING

AERIAL VIEW OF SITE LOOKING NORTH

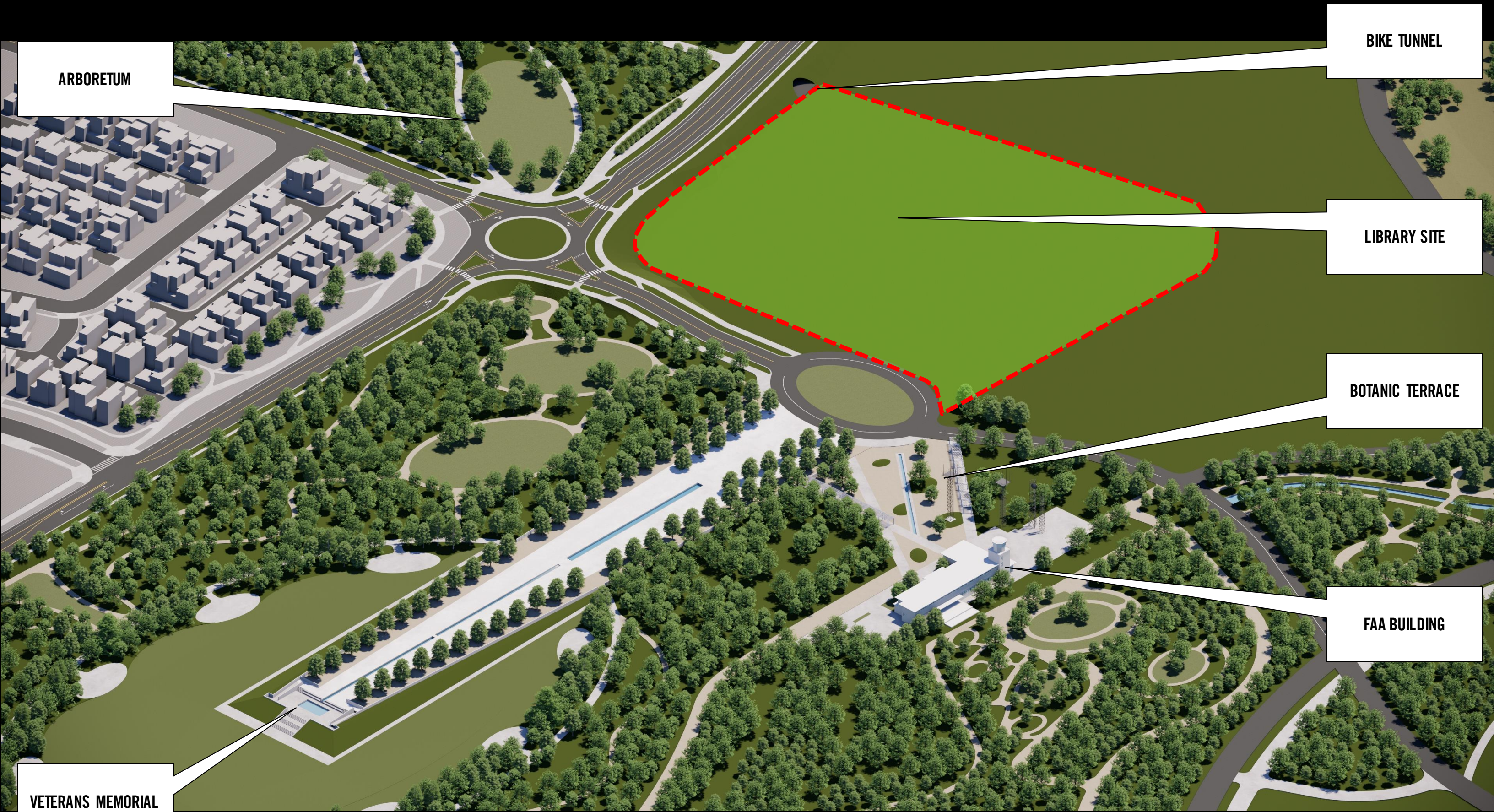

ARBORETUM

BIKE TUNNEL

LIBRARY SITE

BOTANIC TERRACE

FAA BUILDING

VETERANS MEMORIAL

AERIAL VIEW OF SITE LOOKING EAST

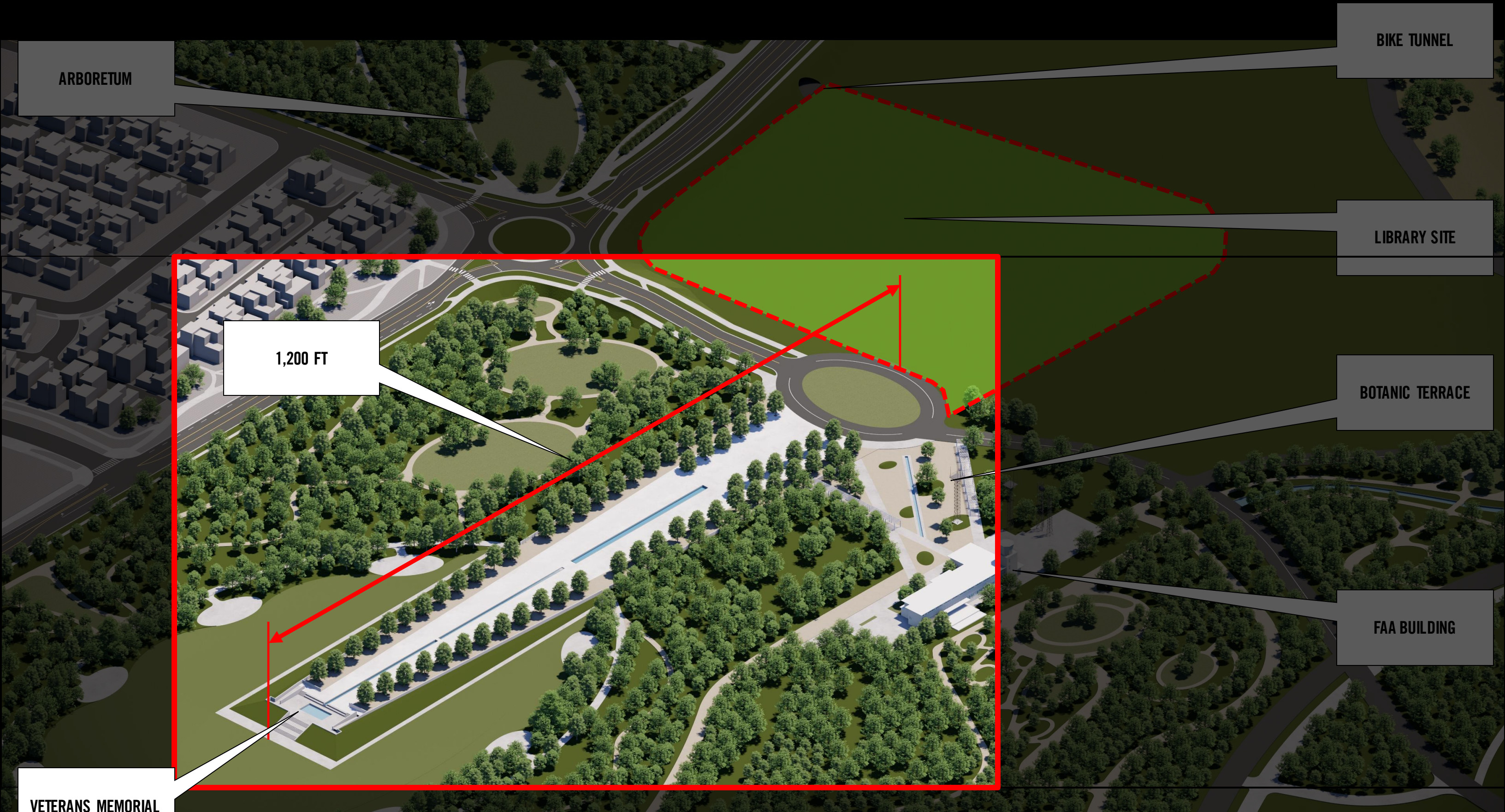

ARBORETUM

BIKE TUNNEL

LIBRARY SITE

1,200 FT

BOTANIC TERRACE

FAA BUILDING

VETERANS MEMORIAL

AERIAL VIEW OF SITE LOOKING EAST



NATIONAL MALL REFLECTING POOL: 2,000 FEET



NATIONAL MALL REFLECTING POOL: 2,000 FEET

VETERANS MEMORIAL

ARBORETUM

BIKE TUNNEL

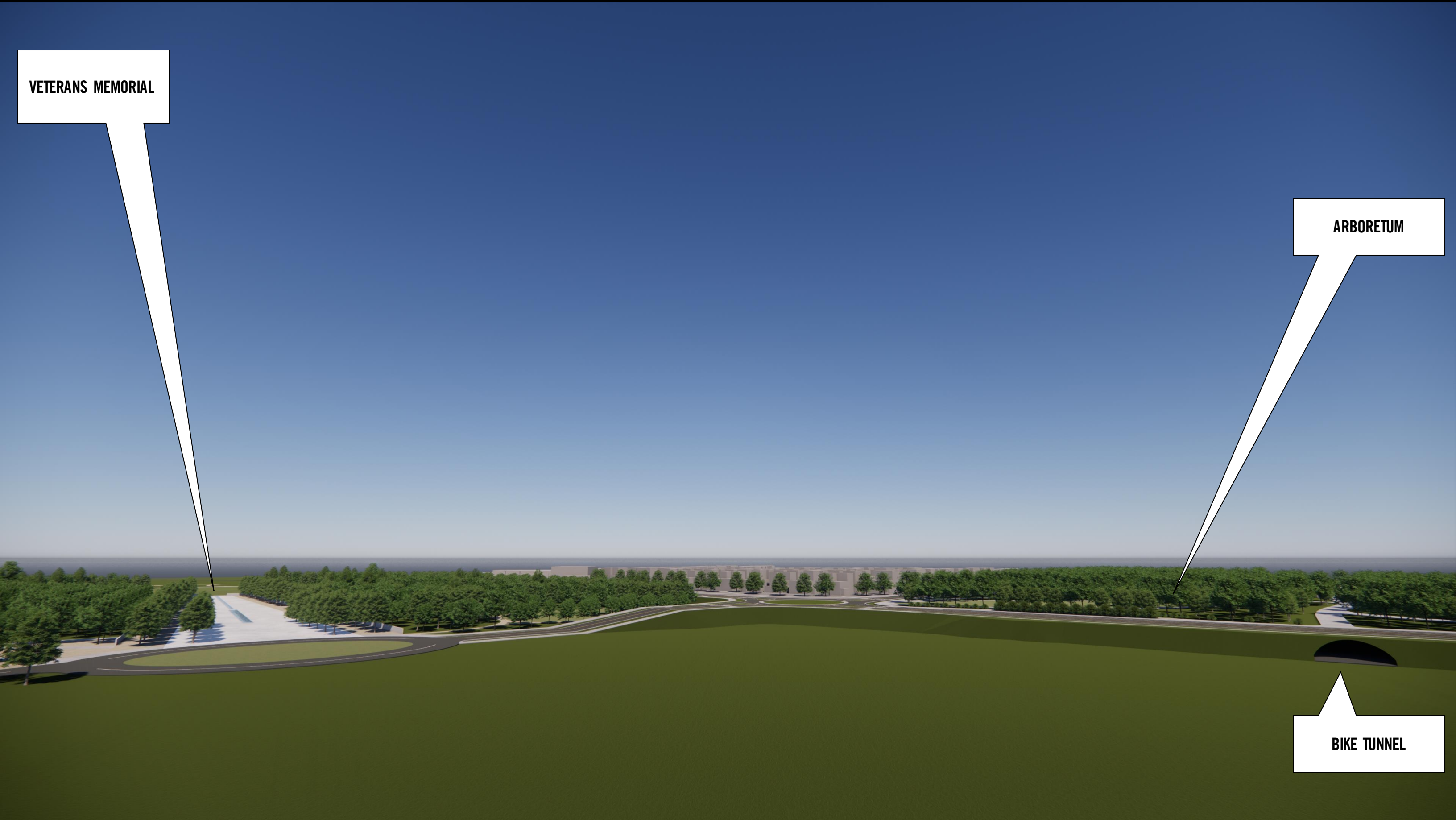

VIEW OF SITE LOOKING NORTH

VETERANS MEMORIAL

ARBORETUM

BIKE TUNNEL

LIBRARY SITE

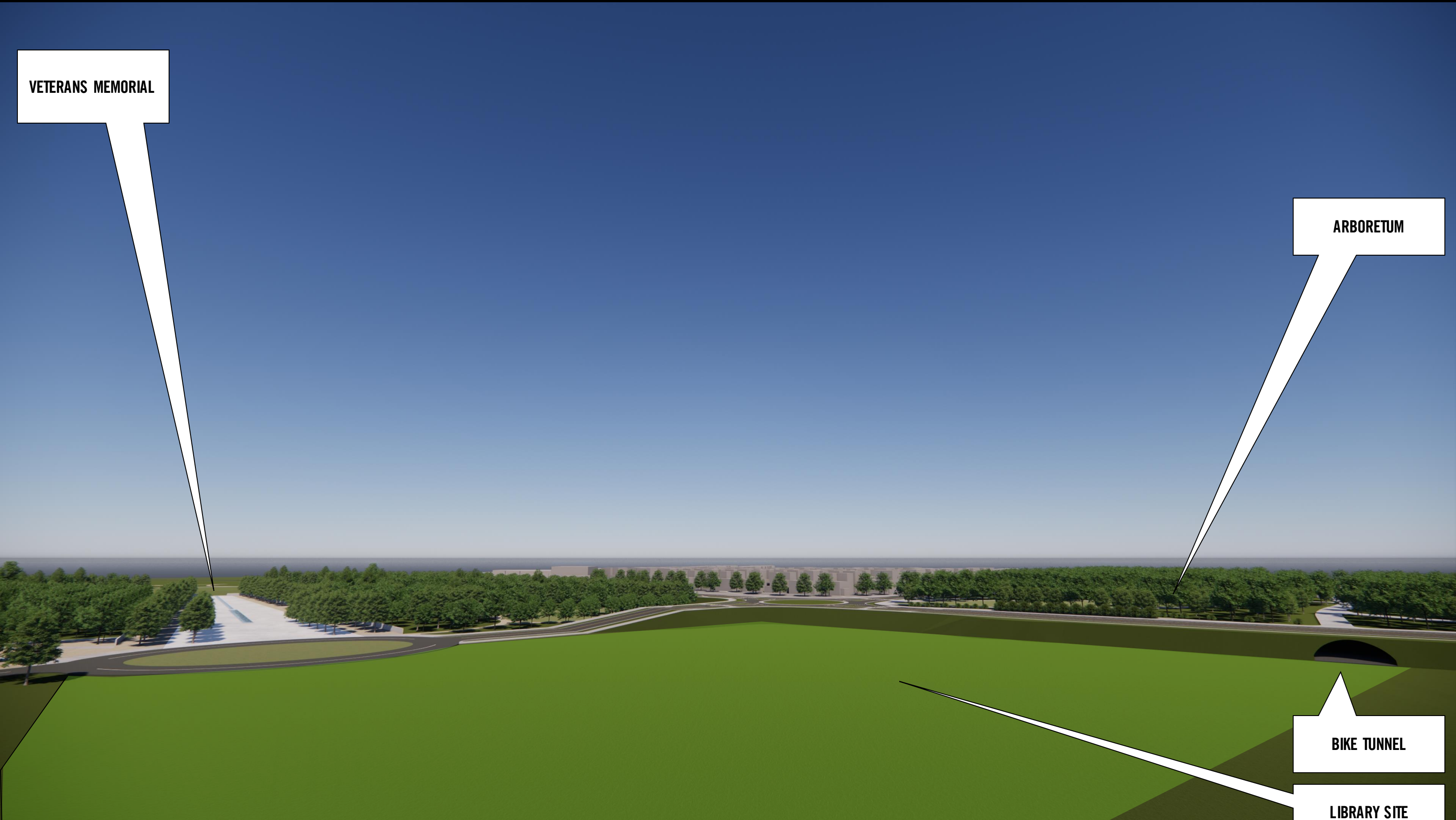

VIEW OF SITE LOOKING NORTH

VETERANS MEMORIAL

ARBORETUM

BERM

BIKE TUNNEL



VIEW OF SITE LOOKING NORTH

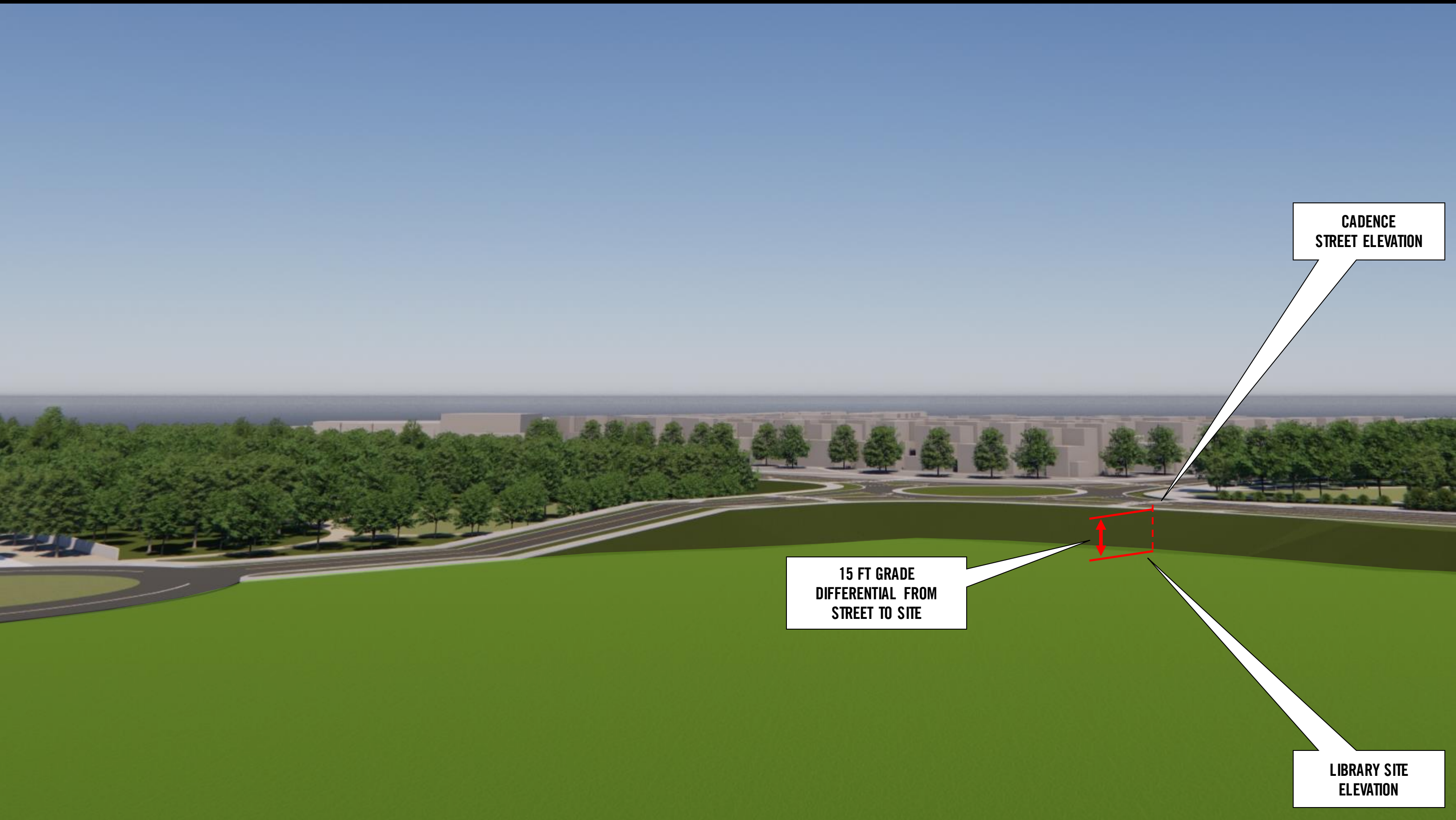

SITE TOPOGRAPHY



Library Program

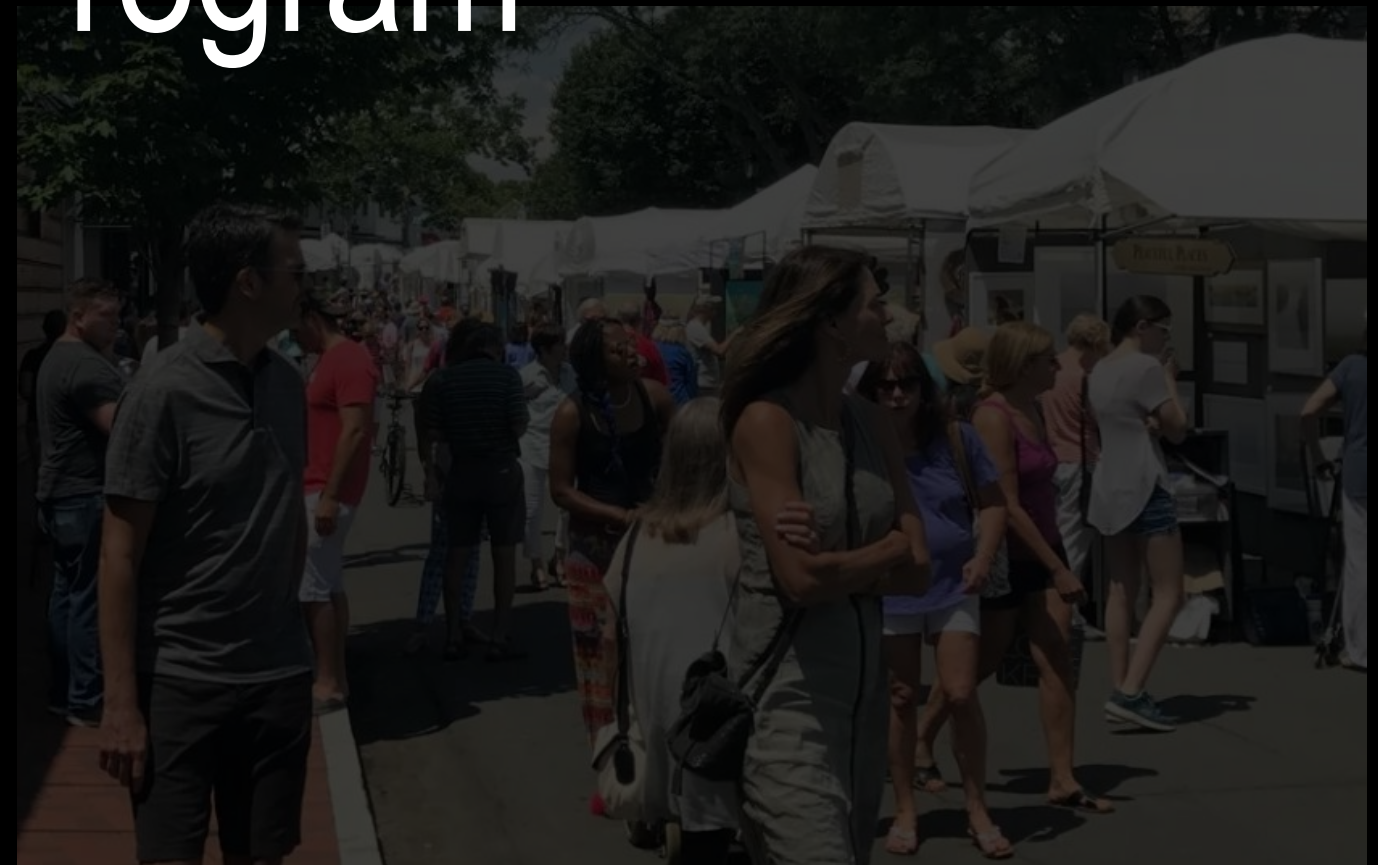
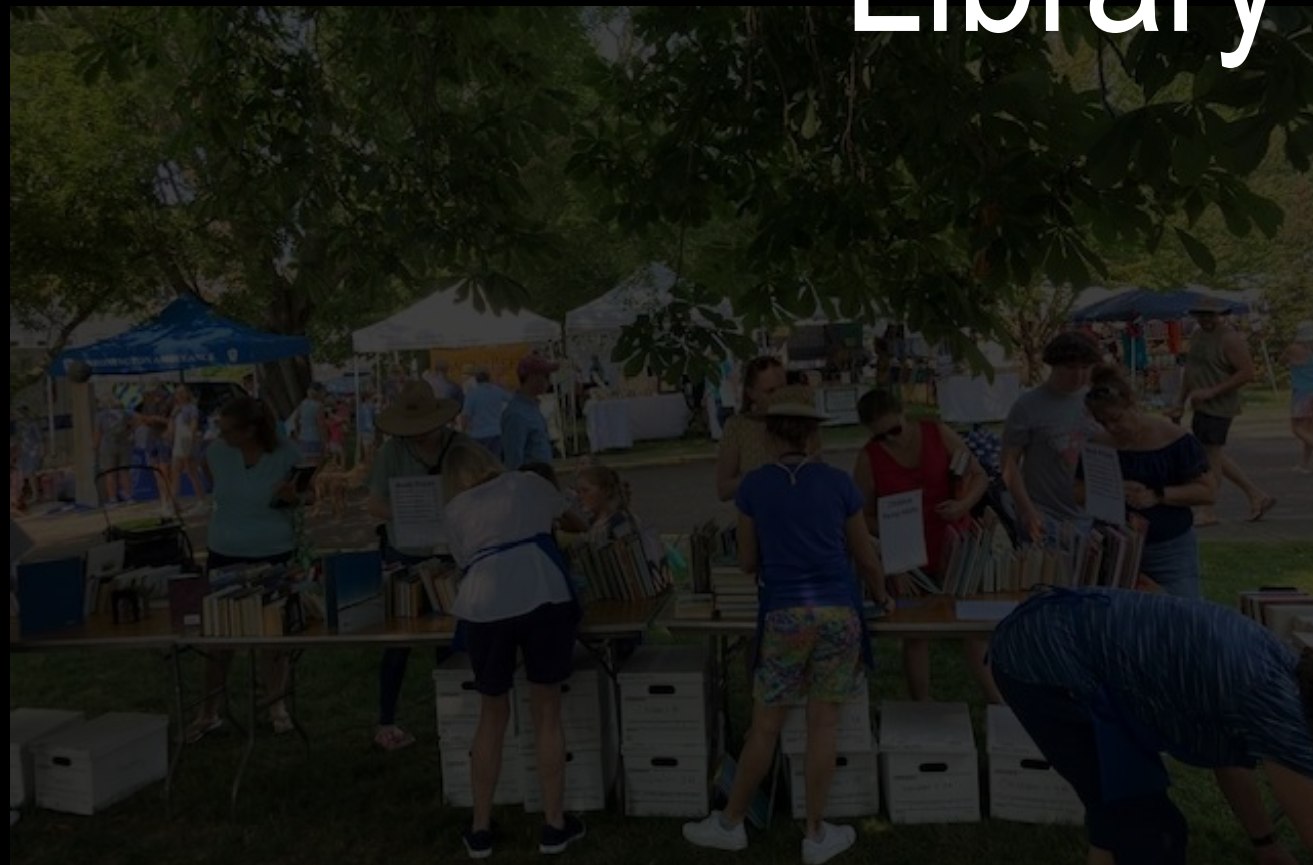

CONCERTS, FESTIVALS, FAIRS & EVENTS



CONCERTS, FESTIVALS, FAIRS & EVENTS



CONCERTS, FESTIVALS, FAIRS & EVENTS



THE LIBRARY OUTDOORS



CHILDREN'S LIBRARY AND AN OUTDOOR LEARN/PLAY AREA



LIBRARY CAFE



CULINARY/ NUTRITION / WELLNESS

Program

- Adult/Young Adult Collection: 150,000 volumes

Program

- Adult/Young Adult Collection: 150,000 volumes
- Children/Juvenile Collection: 120,000 volumes

Program

- Adult/Young Adult Collection: 150,000 volumes
- Children/Juvenile Collection: 120,000 volumes
- Multi-media & Periodicals: 20,000 items

Program

- Adult/Young Adult Collection: 150,000 volumes
- Children/Juvenile Collection: 120,000 volumes
- Multi-media & Periodicals: 20,000 items
- Total Collection: 290,000 items
- Does not include collection at branches

Program

- International languages collection (Adult & Children's): 15,000 volumes
- Marine Corps Research Library
- Veteran's Support Services
- Local History collection & archives
- Partnership with UCI to access University Archives

Program

- Includes floor area for Irvine Public Library system administration to support a minimum of four future branch libraries.

Program

- Includes floor area for Irvine Public Library system administration to support a minimum of four future branch libraries.
- Minimum likely size of a future branch library will be 30,000 to 35,000 SF.

Program

- Includes floor area for Irvine Public Library system administration to support a minimum of four future branch libraries.
- Minimum likely size of a future branch library will be 30,000 to 35,000 SF.
- Statewide benchmarks: Central Library to serve a population between 300,000 and 450,000 is 80,000 SF to 100,000 SF.

For Comparison

POPULATION

	Population	Central Library (SF)	Number of Branch Libraries	Branch Libraries (SF)	Library Square Feet per Capita
Irvine	303,051	0	3	43,661	0.14
Long Beach	456,062	94,650	11	103,120	0.43
Cerritos	48,394	88,500	0	0	1.83
Anaheim	345,940	67,500	7	82,302	0.43
Santa Monica	93,000	110,000	4	32,376	1.53
Newport Beach	84,792	71,000	3	25,106	1.13

CITY OF IRVINE: 303,051 RESIDENTS; 66 SQUARE MILES; 12.5 MILES ACROSS

For Comparison

CENTRAL LIBRARY & BRANCHES

BRANCH LIBRARIES SQUARE FOOTAGE

	Population	Central Library (SF)	Number of Branch Libraries	Branch Libraries (SF)	Library Square Feet per Capita
Irvine	303,051	0	3	43,661	0.14
Long Beach	456,062	94,650	11	103,120	0.43
Cerritos	48,394	88,500	0	0	1.83
Anaheim	345,940	67,500	7	82,302	0.43
Santa Monica	93,000	110,000	4	32,376	1.53
Newport Beach	84,792	71,000	3	25,106	1.13

CITY OF IRVINE: 303,051 RESIDENTS; 66 SQUARE MILES; 12.5 MILES ACROSS

For Comparison

CENTRAL LIBRARY & BRANCHES

TOTAL LIBRARY FLOOR AREA PER CAPITA

	Population	Central Library (SF)	Number of Branch Libraries	Branch Libraries (SF)	Library Square Feet per Capita
Irvine	303,051	0	3	43,661	0.14
Long Beach	456,062	94,650	11	103,120	0.43
Cerritos	48,394	88,500	0	0	1.83
Anaheim	345,940	67,500	7	82,302	0.43
Santa Monica	93,000	110,000	4	32,376	1.53
Newport Beach	84,792	71,000	3	25,106	1.13

CITY OF IRVINE: 303,051 RESIDENTS; 66 SQUARE MILES; 12.5 MILES ACROSS

For Comparison

CENTRAL LIBRARY & BRANCHES

TOTAL LIBRARY FLOOR AREA PER CAPITA

	Population	Central Library (SF)	Number of Branch Libraries	Branch Libraries (SF)	Library Square Feet per Capita
Irvine	303,051	0	3	43,661	0.14
Long Beach	456,062	94,650	11	103,120	0.43
Cerritos	48,394	88,500	0	0	1.83
Anaheim	345,940	67,500	7	82,302	0.43
Santa Monica	93,000	110,000	4	32,376	1.53
Newport Beach	84,792	71,000	3	25,106	1.13

STATE MEDIAN: .46 SF/CAPITA

.43 SF/ CAPITA

CITY OF IRVINE: 303,051 RESIDENTS; 66 SQUARE MILES; 12.5 MILES ACROSS

For Comparison

CENTRAL LIBRARY & BRANCHES

TOTAL LIBRARY FLOOR AREA PER CAPITA

	Population	Central Library (SF)	Number of Branch Libraries	Branch Libraries (SF)	Library Square Feet per Capita
Irvine	303,051	0	3	43,661	0.14
Long Beach	456,062	94,650	11	103,120	0.43
Cerritos	48,394	88,500	0	0	1.83
Anaheim	345,940	67,500	7	82,302	0.43
Santa Monica	93,000	110,000	4	32,376	1.53
Newport Beach	84,792	71,000	3	25,106	1.13

STATE MEDIAN: .46 SF/CAPITA

1.83 SF/ CAPITA

CITY OF IRVINE: 303,051 RESIDENTS; 66 SQUARE MILES; 12.5 MILES ACROSS

For Comparison

CENTRAL LIBRARY & BRANCHES

TOTAL LIBRARY FLOOR AREA PER CAPITA

	Population	Central Library (SF)	Number of Branch Libraries	Branch Libraries (SF)	Library Square Feet per Capita
Irvine	303,051	0	3	43,661	0.14
Long Beach	456,062	94,650	11	103,120	0.43
Cerritos	48,394	88,500	0	0	1.83
Anaheim	345,940	67,500	7	82,302	0.43
Santa Monica	93,000	110,000	4	32,376	1.53
Newport Beach	84,792	71,000	3	25,106	1.13

STATE MEDIAN: .46 SF/CAPITA

.43 SF/ CAPITA

CITY OF IRVINE: 303,051 RESIDENTS; 66 SQUARE MILES; 12.5 MILES ACROSS

For Comparison

CENTRAL LIBRARY & BRANCHES

TOTAL LIBRARY FLOOR AREA PER CAPITA

	Population	Central Library (SF)	Number of Branch Libraries	Branch Libraries (SF)	Library Square Feet per Capita
Irvine	303,051	0	3	43,661	0.14
Long Beach	456,062	94,650	11	103,120	0.43
Cerritos	48,394	88,500	0	0	1.83
Anaheim	345,940	67,500	7	82,302	0.43
Santa Monica	93,000	110,000	4	32,376	1.53
Newport Beach	84,792	71,000	3	25,106	1.13

STATE MEDIAN: .46 SF/CAPITA

1.53 SF/ CAPITA

CITY OF IRVINE: 303,051 RESIDENTS; 66 SQUARE MILES; 12.5 MILES ACROSS

For Comparison

CENTRAL LIBRARY & BRANCHES

TOTAL LIBRARY FLOOR AREA PER CAPITA

	Population	Central Library (SF)	Number of Branch Libraries	Branch Libraries (SF)	Library Square Feet per Capita
Irvine	303,051	0	3	43,661	0.14
Long Beach	456,062	94,650	11	103,120	0.43
Cerritos	48,394	88,500	0	0	1.83
Anaheim	345,940	67,500	7	82,302	0.43
Santa Monica	93,000	110,000	4	32,376	1.53
Newport Beach	84,792	71,000	3	25,106	1.13

STATE MEDIAN: .46 SF/CAPITA

1.13 SF/ CAPITA

CITY OF IRVINE: 450,000 POPULATION IN 15 YEARS = 225,000 SF

For Comparison

ASSUMING 450,000 POPULATION IN 15 YEARS = 225,000 SF OF LIBRARY FLOOR AREA BETWEEN CENTRAL LIBRARY AND BRANCHES

TOTAL LIBRARY FLOOR AREA PER CAPITA

	Population	Central Library (SF)	Number of Branch Libraries	Branch Libraries (SF)	Library Square Feet per Capita
Irvine	303,051	0	3	43,661	0.14
Long Beach	456,062	94,650	11	103,120	0.43
Cerritos	48,394	88,500	0	0	1.83
Anaheim	345,940	67,500	7	82,302	0.43
Santa Monica	93,000	110,000	4	32,376	1.53
Newport Beach	84,792	71,000	3	25,106	1.13

STATE MEDIAN: .46 SF/CAPITA

1.13 SF/ CAPITA

CITY OF IRVINE: 450,000 POPULATION IN 15 YEARS = 225,000 SF



CITY OF LONG BEACH: BILLIE JEAN KING MAIN LIBRARY - 94,650 SF MAIN LIBRARY; COMPLETED IN 2019



CITY OF CERRITOS: 88,500 SF LIBRARY; COMPLETED IN 2002; SINGLE LIBRARY SYSTEM



CITY OF NEWPORT BEACH: 71,000 SF LIBRARY ; 2013 EXPANSION



CITY OF SANTA MONICA: 110,000 SF; BUILT IN 2006





CAMBRIDGE, MA



AUSTIN, TX

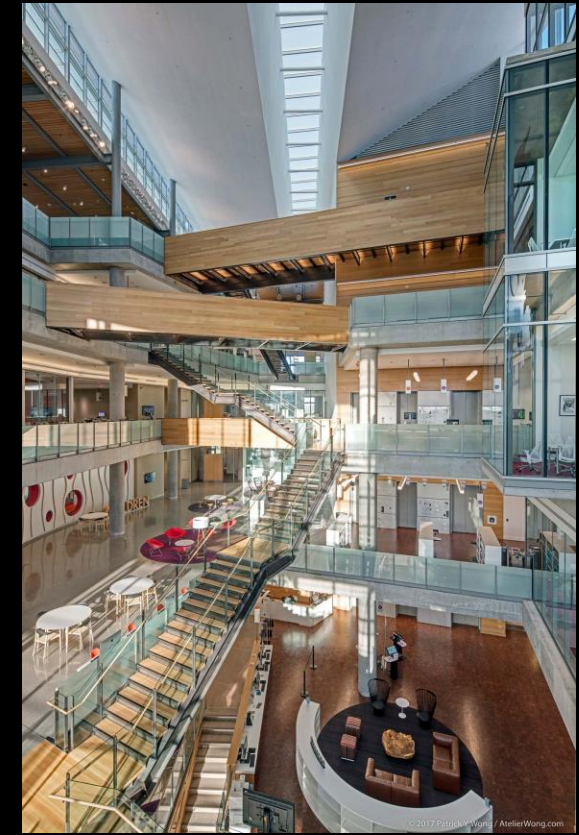

CHICAGO, IL

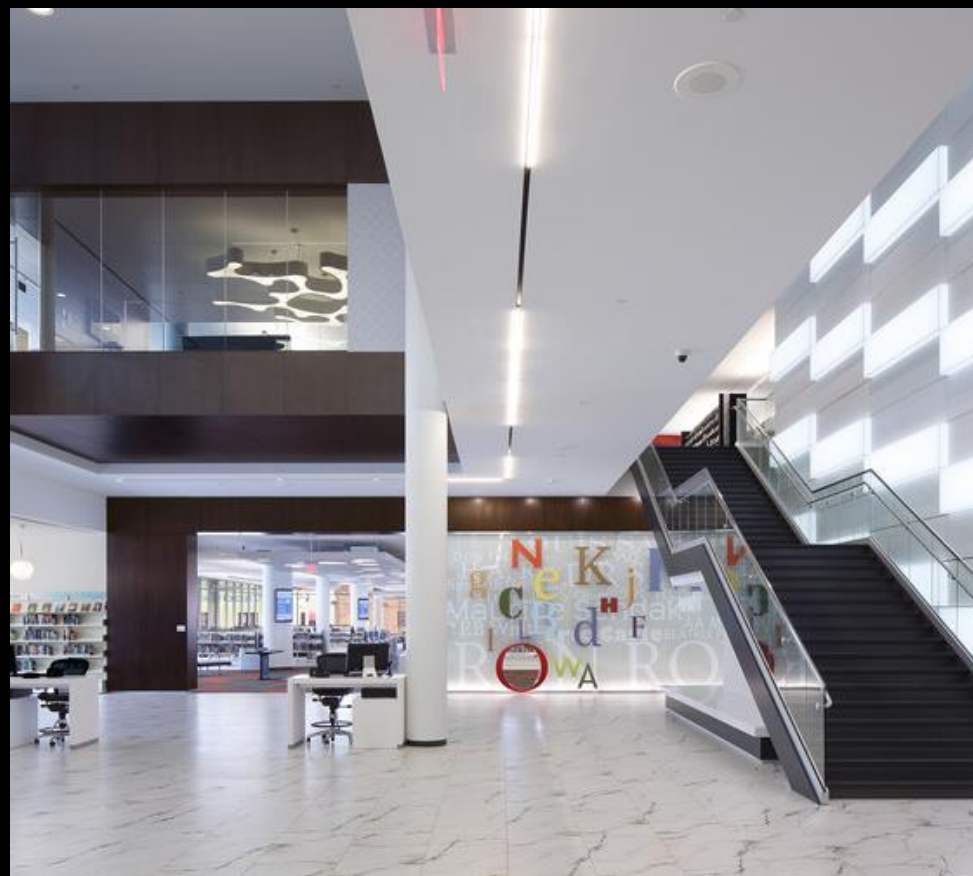

CEDAR RAPIDS, IA

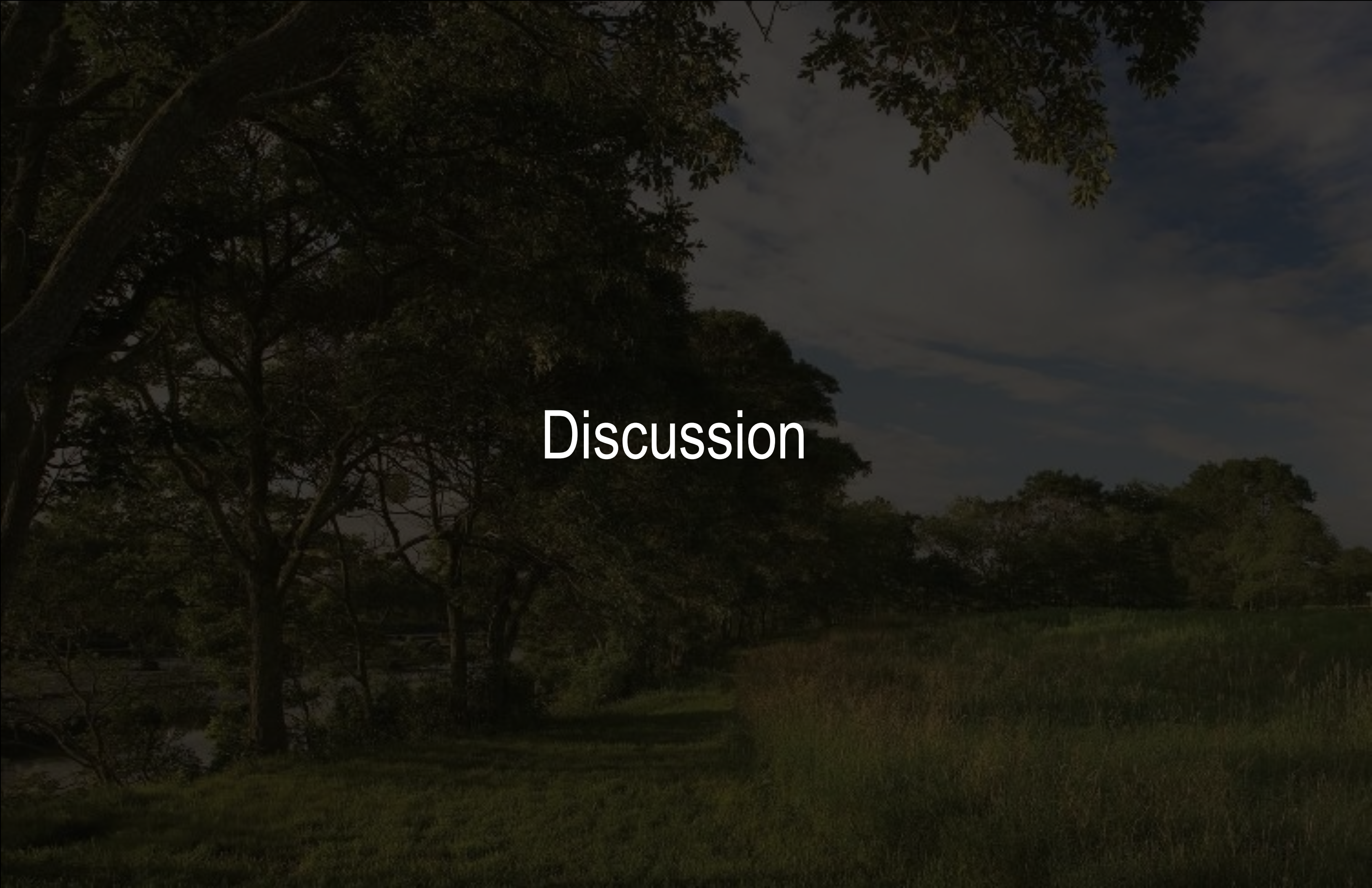

NORFOLK, VA

A dark, atmospheric landscape featuring a line of trees on the left and a field of tall grass on the right, under a cloudy sky. The scene is dimly lit, creating a moody and somber atmosphere. The trees are silhouetted against the sky, and the grass in the foreground is dark and textured.

Discussion

