

Irvine Public Library

Informational Meeting



City of Irvine



Overview of OC Public Libraries in Irvine



Katie Wheeler
11,250 Sq.Ft.
Built: 2008
Ownership: OCPL



Heritage Park
21,000 Sq.Ft.
Built: 1988
Ownership: City
(55-year lease to OCPL)



University Park
11,411 Sq.Ft.
Built: 1975
Ownership: OCPL



Background

- On July 23, 2024, the Irvine City Council approved the library transition from County to City-operated libraries
- August 2024, the Orange County Board of Supervisors finalized the agreement
- Per the agreement, the City is scheduled to take over facilities effective July 1, 2025

City of Irvine



Recent Updates

- On January 14, 2025, the Irvine City Council approved a 3-year lease for the Katie Wheeler Library
- On January 28, 2025, the Irvine City Council approved a budget to support the next phase of recruiting staff, enhancing library collections, and making improvements to the Heritage Park and University Park facilities



Transition Plan Key Dates

Timeline	
Through March 31, 2025	OCPL operates Heritage Park Library, University Park Library, and Katie Wheeler Library at current service levels
April 1, 2025– May 15, 2025	OCPL operates Heritage Park Library, University Park Library, and Katie Wheeler Library at reduced service levels.
May 16, 2025 – June 30, 2025	Heritage Park and University Park Libraries will be closed to finalize the transition. Katie Wheeler Library operates at reduced services levels.
July 1, 2025	Heritage Park and University Park Libraries will transition as the first branches of a new city-run Irvine Public Library System with a tentative reopening of August 4; Katie Wheeler Library will be closed; the City will take over the lease and facility starting January 1, 2026; Irvine residents will maintain a right to access items located within the County Library System now & after transition by visiting an OCPL branch

Community Benefits

- Allow for Irvine residents to be more involved in the vision for their libraries
- Stronger community engagement through enhanced programs and outreach services
- Better lending collections that reflect the diverse and growing needs of the community
- Innovative library services that promote creativity and life-long learning skills
- More control of library buildings, including making them more welcoming and comfortable spaces



Next Steps

- Recruit library staff
- Begin to improve the buildings
- Begin to enhance the collections
- Begin to plan and prepare library programs
- Begin to work with our Friends of the Library Groups
- Explore options for additional facilities in the City of Irvine



What is a Library?

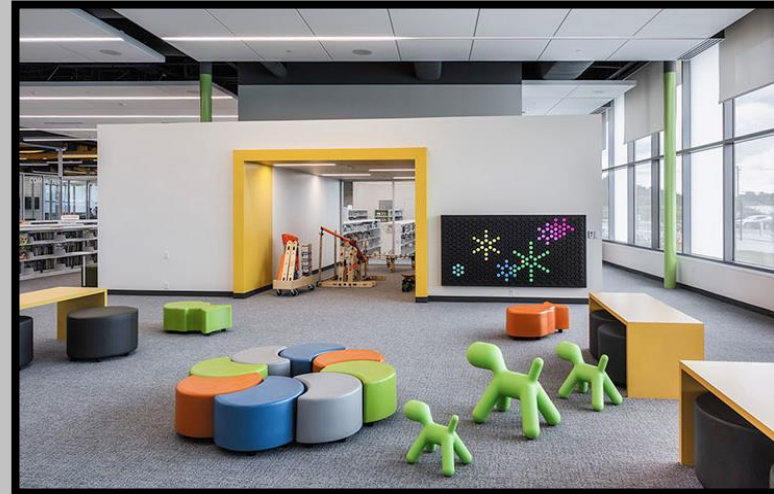

We want to hear from you!

- Let us know what you would like to see for the Irvine Public Libraries!
- Stay up to date with the transition of services and key dates by:
 - Visiting cityofirvine.org/libraries
 - Following us on social media
 - Subscribing to the City of Irvine email updates

